

single room in NO.2 Building

A Room with skylight

about 21m² built-up area
about 15m² utilization area

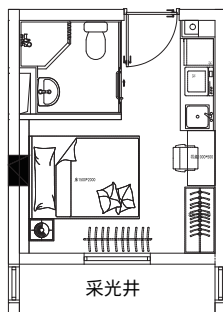

B Room with skylight

about 25m² built-up area
about 18m² utilization area

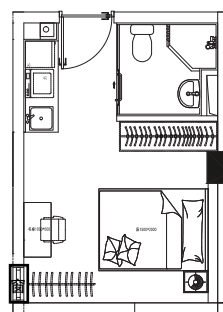

C/D Room C with skylight Room D with French windows

about 28m² built-up area
about 20m² utilization area

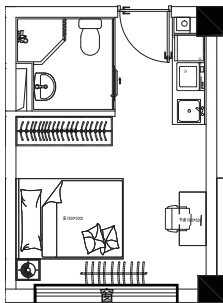

E1 Courtyard Room

about 43m² built-up area
about 31m² utilization area

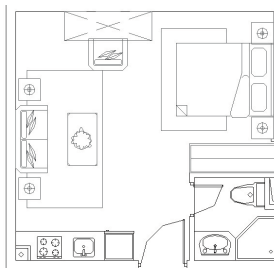

 1.5m bed, bedstand, desk with chair, wardrobe, water-heater, 1.5p air conditioner, pulsator washing machine, refrigerator

The equipment and facilities might be changed.
The image shown here is for reference only, the actual room does not include the soft furniture in the photo and the actual product may differ.
Unijia reserve the right of final explanation.
The apartment will be put into use in September 2018.

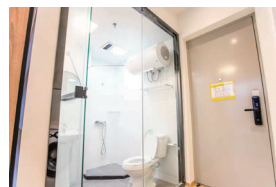
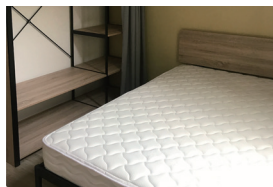

Room Rate

Regular lease

(140Days)

Type	Regular lease		All-inclusive price for Regular Lease	
	RMB	Dollar	RMB	Dollar
A/B	175/day/room	26usd/day/room	215/day/room	32usd/day/room
C	185/day/room	28usd/day/room	225/day/room	34usd/day/room
D	200/day/room	32usd/day/room	240/day/room	36usd/day/room

Irregular lease

(Rent for more than 120 days)

Type	Irregular lease (≥120days)		All-inclusive price for Irregular lease (≥120days)	
	RMB	Dollar	RMB	Dollar
A/B	205/day/room	31usd/day/room	245/day/room	37usd/day/room
C	215/day/room	32usd/day/room	255/day/room	38usd/day/room
D	230/day/room	34usd/day/room	270/day/room	40usd/day/room

Room E

(Rent for more than 4 months)

Type	≥4 months		≥4 months (All-inclusive)	
	RMB	Dollar	RMB	Dollar
E1	6900/month/room	1030/month/room	8100/month/room	1209/month/room

! Utility bills

- 1. **All-inclusive Price:**
40 yuan/day (6 usd/ day) for room independent broadband, water and electricity charges, will be charged synchronously with the rent.
- 2. **Water and electricity charges shall be settled according to actual use:**
Electricity charge: 1.65 yuan/degree; Water rate: 6.5 yuan/ton
Net fee: 80 yuan/month; Bedding: 800 yuan/set (129usd/set)
Charge rmb1,000 in advance for energy expenses when you check in, and settle energy bills every month.
- 3. Choose one of the two payment methods.

The price is valid until Jun 30 2020.

* optional bedding bag for check-in, 800 yuan/set (\$129), including a pillow, quilt, three pieces (pillowcase, bed-cover, sheet).

15021336008

www.unijia.net

booking@unijia.net



Double room About 27 m² (Built-up area)

1x2m bed, bedstand, desk+chair, wardrobe, water-heater, 1.5p air conditioner, washing machine, refrigerator

The equipment and facilities might be changed.
The image shown here is for reference only, the actual room does not include the soft furniture in the photo and the actual product may differ.
Unijia reserve the right of final explanation.
The apartment will be put into use in September 2018.



public area



public kitchen



gym



public area



public area

Room rate

Regular lease

(140Days)

Type	Regular lease		All-inclusive price for Regular lease	
	RMB	Dollar	RMB	Dollar
double c	110/day/person	16usd/day/person	130/day/person	19usd/day/person
double d	120/day/person	18usd/day/person	140/day/person	21usd/day/person

Irregular lease

(Rent for more than 120 days)

Type	Irregular lease (≥120days)		All-inclusive price for Irregular lease (≥120days)	
	RMB	Dollar	RMB	Dollar
double c	125/day/person	19usd/day/person	145/day/person	22usd/day/person
double d	135/day/person	20usd/day/person	155/day/person	23usd/day/person

Traffic Information



To Fudan University

No.966/59/854
10min

By bike
5min

on foot
10min

To Tongji University

No.959
10min

By bike
5min

on foot
20min

Booking & Check-in process

- Booking via email (please provide required booking information and passport copy). Passport and school admission notice need to be provided upon check-in.
- All rent must be paid before check-in. Payment methods: Overseas bank transfer to unijia company account, bank transfer within China, credit card payment within China.
- When you check in, you need to pay the deposit and charge for utilities in advance. The deposit is about 4000 yuan/room (2000yuan/person for double room), and the deposit is 1,000 yuan/room for utilities in advance (Customers who opt for the all-inclusive package will no longer charge pre-paid utilities). The payment method is RMB cash. The deposit will be returned after the lease ends and the utilities will be paid in advance.
- Take card/password after check-in procedure.

Booking Tips

Welcome to unijia International Students Community.
You can booking the apartment by send email to (booking@unijia.net), and we will allocate the room according to reply time of your email and your room choice.

- ✉ Please use the format of "Passport name+ Gender+Room choice" in the subject of your mail.
- 📧 Please submit your application information in email as the following format together your passport copy and Accommodation registration form.

The online application number	Passport name	Nationality	Passport Number
e.g. c2016079012	Mike Wong	USA	123456
Gender (M or F)	Room choice (First choice/Second choice)	Regular contract duration (1 semester or 1 year (2 semesters) or full July term or full August term)	Irregular contract duration: yy-mm-dd to yy-mm-dd (irregular contract duration will lead to rise of room rate)
M	A/B/C	One year	18-04-01 to 18-12-01

- 📄 We will reply your e-mail to confirm your booking with following deposit and rent payment arrangements and what you should do for the next step. Please read the two files: [unijia International Student Community Regulations](#) and [The Housing Contract for International Students at unijia International Student Community](#). It means that you accept the conditions written in the files once you booked the dorm.

Due to the limited source of the house, the company will arrange the room according to the order of the money.
If it can not be paid in time, we will not guarantee the reservation of the room.



No. 2 building, leisure square,
#173, Handan Road, Shanghai



15021336008



booking@unijia.net